

Cim 2511

MAGNETIC SCALE INHIBITOR COUPLING - COPPER/COPPER



This article was made in compliance with the quality management requirements of standard ISO 9001:2008. All articles are tested according to the standard EN 12266-1:2003. It can be used in drinking water distribution networks and sanitary systems to reduce the effects of limestone. It is made of a brass alloy that complies with standard EN 12165-CW617N-M.

Nominal Pressure: PN16
Operating temperature: 0 ÷ 40°C

FLOW AND PRESSURE DROP

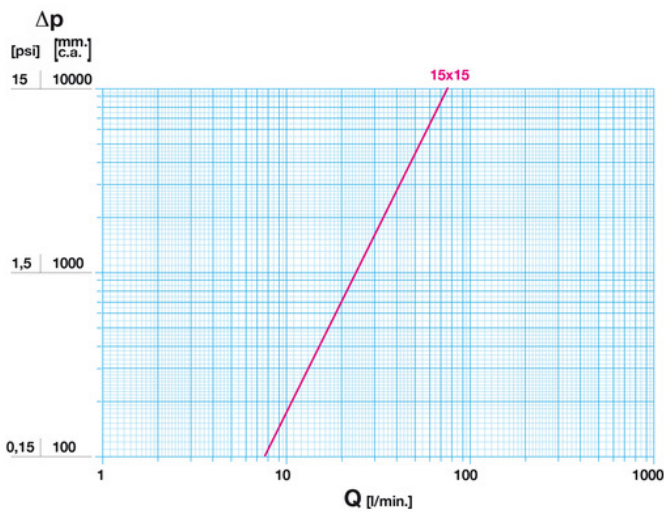

Notes:
1 l/min = 0,06 m3/h
1 m3/h = 16,67 l/min
1 bar = 10.000 mm w.c.
1 psi = 690 mm w.c.

PRESSURE TEMPERATURE RATINGS

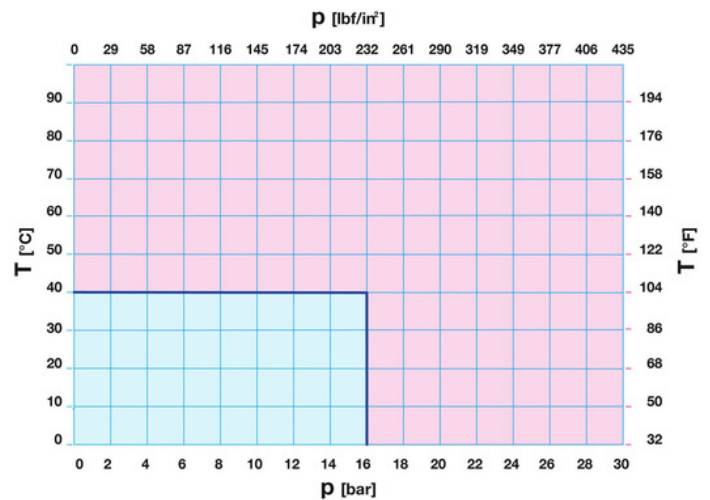

Notes:
1 bar = 14,5 psi
1 bar = 14,5 lbf/in²
°C = 5/9 x (°F-32)
°F = 32 + (9/5 x °C)

TECHNICAL DRAWING

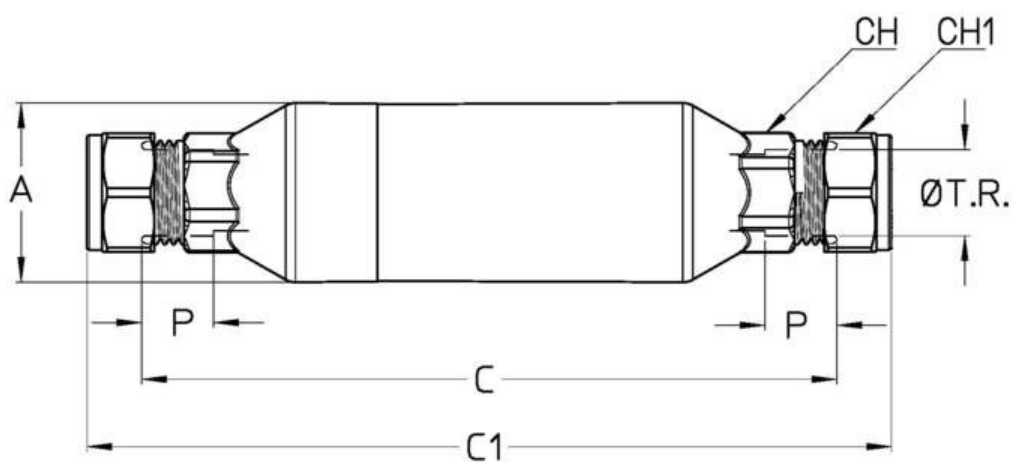

Ø T.R.	15
Grms.	455
A	36
C	145
C1	162
P	13
CH	22
CH1	24

Compression fitting

TECHNICAL CHARACTERISTICS

KV	
Ø T.R.	15
KV	4,6

KV = Flow rate in m³/h with a pressure drop of 1 bar

OUR CERTIFICATIONS

EAC